

M35J

HIGH MODULUS CARBON FIBER

M35J carbon fiber is an MJ-type high modulus fiber with enhanced tensile and compressive strength as compared to M series fibers. Manufactured in Japan.

PRODUCT DESIGNATION

M35J	B	12,000	5	0	B
Fiber Type	Twist*	Filament Count	Sizing Type	Surface Treatment	Sizing Amount

* B: Untwisted

FIBER PROPERTIES

PROPERTY	ENGLISH	METRIC	METHOD
Tensile Strength 6K	654 ksi	4,510 MPa	TY-030B-01
Tensile Strength 12K	683 ksi	4,700 MPa	TY-030B-01
Tensile Modulus	49.8 Msi	343 GPa	TY-030B-01
Strain at Failure 6K		1.3%	TY-030B-01
Strain at Failure 12K		1.4%	TY-030B-01
Density		1.75 g/cm ³	TY-030B-02
Filament Diameter		5 μm	
Yield	6K	225 g/1000m	TY-030B-03
	12K	450 g/1000m	TY-030B-03

FUNCTIONAL PROPERTIES

PROPERTY	VALUE
CTE	-0.73 α · 10 ⁻⁶ /°C
Specific Heat	0.723 J/g · °C
Thermal Conductivity	0.389 J/cm · s · °C
Electric Resistivity	1.1 x 10 ⁻³ Ω · cm
Chemical Composition: Carbon	>99%
Na + K	<50 ppm

RESIN SYSTEM COMPATIBILITY

SIZING TYPE & AMOUNT	RESIN SYSTEM COMPATIBILITY	METHOD
50B (1.0 %)	Epoxy, phenolic, polyester, vinyl ester	TY-030B-05

COMPOSITE PROPERTIES

PROPERTY	ENGLISH	METRIC	METHOD
Tensile Strength*	390 ksi	2,690 MPa	ASTM D-3039
Tensile Modulus*	29 Msi	202 GPa	ASTM D-3039
Tensile Strain		1.35%	ASTM D-3039
Compressive Strength*	203 ksi	1,400 MPa	SACMA SRM 1R-94
Flexural Strength*	239 ksi	1,650 MPa	ASTM D-790
Flexural Modulus*	25 Msi	169 GPa	ASTM D-790
ILSS	12 ksi	83.6 MPa	SACMA SRM 8R-94
In Plain Shear Strength	19 ksi	131 MPa	ASTM D-3518
90° Tensile Strength	10 ksi	68 MPa	ASTM D-3039

*Normalized to 60% fiber volume. Cured with #2592 epoxy at 130 °C.



PACKAGING

The table below summarizes the tow sizes, twists, sizing types, and packaging available for standard material. Other bobbin sizes may be available on a limited basis.

TOW SIZES	BOBBIN NET WEIGHT (kg)	BOBBIN TYPE	BOBBIN SIZE (mm)					SPOOL PER CASE	CASE NET WEIGHT (kg)
			a	b	c	d	e		
6K	1.0	II	76	82	192	126	156	12	12
12K	2.0	II	76	82	192	157	156	12	24

Bobbin Type:

Type II

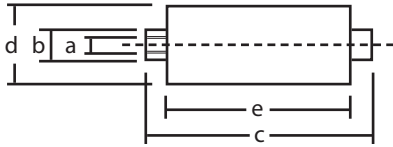

Please refer to SDS for handling and disposal.

For more information or purchasing inquiries:
sales@toraycma.com | www.toraycma.com | 253-846-1777